

28th ANNUAL

Franklin - Sterling

MINERAL EXHIBIT

The Fluorescent Mineral Capitol of the World

Sat. & Sun., October 6th & 7th, 1984



Sponsored by

**KIWANIS CLUB OF FRANKLIN
FRANKLIN, NEW JERSEY**

PRICE 50¢

MINERAL

S
H
O
W
C
A
S
E

FREE, EDUCATIONAL, NON-PROFIT
MINERAL MUSEUM

SPECIMENS FROM WORLD WIDE LOCATIONS



**GERMAN CARVINGS
KNOTTED GEM BEADS
BOOKS, SPECIMENS, STONES**



**WE BUY
MINERAL COLLECTIONS
("FRANKLIN" of SPECIAL INTEREST)**

LEE & JENNIE ARESON

TEL. (914) 343-5051

21 IRWIN AVENUE

MIDDLETOWN, NEW YORK 10940

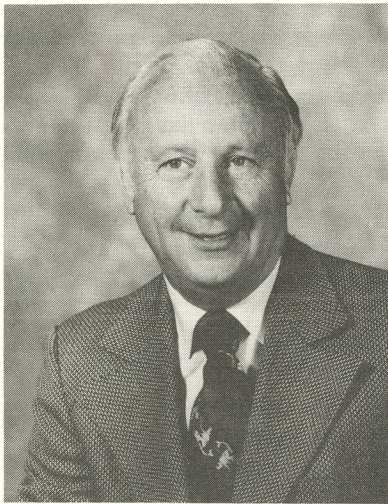

Kiwanis Club of Franklin
Honors Charter Member
EMANUEL A. HONIG

Emanuel "Manny" Honig, the lone Charter Member of our Club, has been an active member of the Kiwanis Club and the Franklin Mineral Museum since the origin of both organizations. Manny has served as President of the Club and has been a member of the Board of Directors. He has served as a member of the board of the Franklin Mineral Museum, serving as Legal Counsel for both.

Manny's dedication and unusual knowledge of Franklin minerals and its history is due to his serving as attorney for the New Jersey Zinc Company. He served in this capacity until the Franklin Plant of the Zinc Company closed.

Manny was one of the Kiwanis Club members who dismantled the temporary Mine Replica and reassembled the Replica at its present location in the old hoist house which is part of the present Museum's Complex. Manny was instrumental in obtaining the first mortgage ever granted to a service club, which enabled the Franklin Club to erect the Mineral Museum.

Manny's counsel and legal advice and representation to the Kiwanis Club of Franklin is so vast, the financial value is beyond estimation, which we sincerely appreciate. A dedicated servant to the community, Manny's many community services include:

Trustee, N. J. State Bar Association, 1971-1978; Secretary, N. J. State Bar Association, 1973-1974; 2nd Vice President, N. J. State Bar Association, 1974-1975; First Vice President, 1975-1976; President Elect, 1976-1977; President, 1977-1978; Immediate Past President, 1978-1979.

Member President's Committee, N. J. State Bar Association concerned with the establishment of a program to reform the procedural and substantive procedural law of the State of New Jersey through a study to be conducted by New Jersey State Bar Association, 1971-1972.

Chairman, Sussex County Ethics Committee of New Jersey, 1971 and various years prior thereto.

Member Committee of the Commissioner of the Department of Community Affairs on Poverty and Law, 1969 to date.

Special Counsel to New Jersey State Bar Association re litigation before the New Jersey Supreme Court in the matter of State v. Bander, 1970.

Special Counsel to N. J. State Bar Association re prosecution of suit against New Jersey Association of Realtor Boards, et al. to determine the extent to which the public interest requires limitation on the rights of brokers to prepare real estate contract, 1971 to date.

President, Alexander Linn Hospital, Sussex, New Jersey, 1967-1976.

Secretary, Alexander Linn Hospital, Sussex, New Jersey, 1950-1967.

Vice President, Morris-Sussex Regional Health Facilities Planning Council, 1967-1973.

President, Sussex County Bar Association, 1965-1966.

Secretary, Franklin Lanes, Inc., 1963 to date.

Director, Peoples National Bank of Sussex County, 1964-1969.

Secretary, Sussex County Title Service Co., Inc., 1969 to date.

Member, Advisory Board of Directors, New Jersey Bank, 1969 to date.

Chairman, Committee on Law and Poverty, New Jersey State Bar Association, 1965-1969.

Chairman, Committee on Availability of Legal Services, New Jersey State Bar Association, 1969 to date.

Past President, Franklin Little League.

Member, Franklin Recreation Commission, 1966-1971.

Chairman, Franklin Borough Industrial Commission, 1960-1965.

Franklin Borough Attorney, 1962-1974.

Secretary to President of New Jersey Senate, 1951.

Member, New Jersey Supreme Court Committee on the Code of Professional Responsibility, 1970-1974.

Vice President, Somerset-Sussex Legal Services Office, 1971-1974.

Trustee, Northern New Jersey Comprehensive Health Planning Council, 1972-1974.

Secretary, Northwest Jersey Health Care Corporation, 1971-1977.

Chairman, Special Committee on Prepaid Legal Services of New Jersey State Bar Association, 1972-1978.

Member, Supreme Court Committee on the Unauthorized Practice of Law, 1974-1977.

Trustee, Walkkill Valley Health Care Corporation.

Member, Special Committee on Prepaid Legal Services, American Bar Association, 1978 to date.

Member, House of Delegates, American Bar Association, 1978 to date.

Trustee, American Prepaid Legal Services Institute, 1983 to date.

Member, New Jersey Supreme Court Committee on the Model Rules of Professional Responsibility, 1983 to date.

Member, Advisory Board of Directors, National Community Bank of New Jersey.

Ken & Betty *Roberts Minerals*

THANK YOU! --- --- ---

Franklin Kiwanis Club
and Franklin Sterling
Hill Gem & Mineral
Show for all your
efforts in producing
this fine show.



P.O. Box 1267 Twain Harte, California 95383 (209-586-2110)

Quality
Mineral
Specimens
for the
Collector
and the
Curator

Showroom by
Appointment

Write or
Phone for
List, Photos,
Specimens
on Approval

We collect
miner's lamps!
buy or
trade

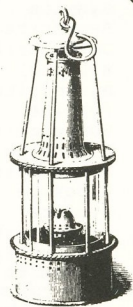

The FRANKLIN-STERLING HILL MINERALS

Edited from numerous sources by John L. Baum, Curator of the Franklin Mineral Museum, August, 1984, following the nomenclature of the 1983 Glossary of Mineral Species, and with special thanks to Pete J. Dunn.

Acanthite	Cahnite	Fluorborite
Acmite	Calcite	Fluorapatite
Actinolite	Canavesite	Fluorite
Adamite	Carrollite	Forsterite
Adelite	Caryopillite	Franklinite
Akrochordite	Celestine	Friedelite
Albite	Celsian	
Allactite	Cerussite	Gageite
Allanite	Chabazite	Gahnite
Alleghanyite	Chalcocite	Galena
Almandine	Chalcophanite	Ganomalite
Analcime	Chalcopyrite	Ganophyllite
Anatase	Charlesite	Gersdorffite
Andradite	Chlorophoenicite	Gerstmannite
Anglesite	Chondrodite	Glaucocroite
Anhydrite	Chrysocolla	Goethite
Annabergite	Chrysotile	Gold
Anorthite	Clinocllore	Goldmanite
Anorthoclase	Clinochrysotile	Graphite
Anthophyllite*	Clinohedrite	Greenockite
Antigorite	Clinohumite	Grossular
Apophyllite	Clinzoisite	Groutite
Aragonite	Conichalcite	Grovesite
Arsenic	Connellite	Guerinite
Arsenopyrite	Copper	Gypsum
Atacamite	Corundum	
Augite	Covellite	Halloysite*
Aurichalcite	Cryptomelane	Hancockite
Austinite	Cuprite	Hardystonite
Azurite	Cuspidine	Hastingsite
		Hauckite
Bakerite	Datolite	Hausmannite
Bannisterite	Descloizite	Hawleyite
Barite	Devilline	Hedenbergite
Barium-pharmacosiderit	Digenite	Hedyphane
Barylite	Diopside	Hematite
Barysillite	Djurleite	Hematolite-like-mineral
Bassanite	Dolomite	Hemimorphite
Baumhauerite	Dravite	Hendricksite
Baumite	Dypingite	Hercynite
Bementite		Hetaerolite
Berthierite	Edenite	Heulandite
Biotite	Epidote	Hexahydrate
Birnessite	Epsomite	Hodgkinsonite
Bornite	Erythrite	Holdenite
Bostwickite	Esperite	Huebnerite
Brandtite	Eveite	Humite
Brochantite		Hyalophane
Brookite	Fayalite	Hydrohetaerolite
Brucite	Feitnechtite	Hydromica*
Brunsvigite	Ferrimolybdite	Hydrotalcite
Bultfonteinite	Ferristilpnomelane	Hydrozincite
Bustamite	Ferroaxinite	
	Flinkite	Illite
		Ilmenite

Jacobsite	Ogdensburgite	Stilpnomelane
Jarosewichite	Ojuelaite	Strontianite
Jerrygibbsite	Orthoclase	Sulfur
Johannsenite	Oyelite*	Sussexite
Johnbaumite	Pararammelsbergite	Svabite
	Parasymplesite	Synadelphite
Kaolinite	Pargasite	
Kentrolite*	Parsettensite*	Talc
Kittatinnyite	Pectolite	Talmessite*
Koettigite	Pharmacosiderite	Tennantite
Kolcicite	Phlogopite	Tephroite
Kraisslite	Picropharmacolite	Thomsonite
Kutnohorite	Pimelite	Thorite*
	Powellite	Thortveitite
Larsenite	Prehnite	Tilasite
Laumontite	Pumpellyite	Tirodite
Lawsonbauerite	Pyrite	Titanite
Lead	Pyroaurite	Todorokite
Legrandite	Pyrobelonite	Torreyite
Lennilenapeite	Pyrochroite	Tremolite
Leucophoenicite	Pyrophanite	
Linarite	Pyroxmangite	Uraninite
Loellingite	Pyrrhotite	Uranophane
Loseyite		Uranospinite
	Quartz	Uvite
Magnesiohornblende		
Magnesianriebeckite	Rammelsbergite	Vesuvianite
Magnesium-chlorophoenicite	Realgar	
Magnetite	Retzian - (Nd)	Wallkilldellite
Magnussonite	Rhodochrosite	Willemite
Malachite	Rhodonite	Wollastonite
Manganaxinite	Richterite	Woodruffite
Manganberzeliite	Riebeckite	Wurtzite
Manganese-hoernesite	Roebblingite	
Manganhumite	Romeite	Xonotlite
Manganosite	Rosasite*	
Manganpyrosmalite	Roweite	Yeatmanite
Marcasite	Rutile	Yukonite
Margarite		
Margarosanite	Safflorite	Zinalsite
Marsturite	Sarkinite	Zincite
Mcallisterite	Sauconite	Zinkenite
Mcgovernite	Schallerite	Zircon
Meionite	Scheelite	
Melanterite*	Scorodite	
Metalodevite	Seligmannite	
Microcline	Sepiolite	Total = 309 species
Mimetite	Serpierite	
Minehillite	Siderite	
Molybdenite	Sillimanite	
Monohydrocalcite	Silver	
Mooreite	Sjogrenite	
Muscovite	Skutterudite	
	Smithsonite	
Nasonite	Sonolite	
Natrolite	Spessartine	
Nelenite	Sphalerite	
Neotocite	Spinel	
Niahite*	Starkeyite	
Newberyite	Sterlinghillite	
Nickeline	Stibnite*	* Reported but not confirmed with certainty.
Nontronite	Stilbite	
Norbergite		



HOMES — LOTS — ACREAGE
LAND INVESTMENT

ONE OF SUSSEX COUNTY'S LEADING REALTORS



Hamburg Corner Shops
Rt. 23 & 94, Hamburg, N.J.

Tel.: 827-6500

Minerals Unique to Franklin and Sterling Hill

BAUMITE	$(\text{Mg}, \text{Mn}, \text{Fe}, \text{Zn})_3(\text{Si}, \text{Al})_2\text{O}_5(\text{OH})_4$
BOSTWICKITE	$\text{CaMn}^{3+}_6\text{Si}_3\text{O}_{16} \cdot 7\text{H}_2\text{O}$
CHARLESITE	$\text{Ca}_6(\text{Al}, \text{Si})_2(\text{SO}_4)_2[\text{B}(\text{OH})_4](\text{OH})_{12} \cdot 26\text{H}_2\text{O}$
CHLOROPHOENICITE	$\text{Mn}_3\text{Zn}_2(\text{OH})_6[\text{As}_0.5\text{H}_0.5(\text{O}, \text{OH})_3]_2$
ESPERITE	$(\text{Ca}, \text{Pb})\text{ZnSiO}_4$
GERSTMANNITE	$(\text{Mg}, \text{Mn})_2\text{ZnSiO}_4(\text{OH})_2$
HANCOCKITE	$(\text{Pb}, \text{Ca}, \text{Sr})_2(\text{Al}, \text{Fe}^{3+})_3(\text{SiO}_4)_3(\text{OH})$
HARDYSTONITE	$\text{Ca}_2\text{ZnSi}_2\text{O}_7$
HAUCKITE	$(\text{Mn}, \text{Mg})_{24}\text{Zn}_{18}\text{Fe}^{3+}_3(\text{SO}_4)_4(\text{CO}_3)_2(\text{OH})_{81}$
HENDRICKSITE	$\text{K}(\text{Zn}, \text{Mg})_3\text{Si}_3\text{AlO}_{10}(\text{OH})_2$
HODGKINSONITE	$\text{Zn}_2\text{Mn}(\text{SiO}_4)(\text{OH})_2$
HOLDENITE	$(\text{Mn}, \text{Mg})_6\text{Zn}_3(\text{OH})_8(\text{AsO}_4)_2(\text{SiO}_4)$
JAROSEWICHITE	$\text{Mn}_2\text{Mn}^{3+}(\text{AsO}_4)(\text{OH})_6$
JERRYGIBBSITE	$\text{Mn}_9(\text{SiO}_4)_4(\text{OH})_2$
JOHNBAUMITE	$\text{Ca}_5(\text{AsO}_4)_3(\text{OH})$
KITTATINNYITE	$\text{Ca}_4\text{Mn}^{3+}_4\text{Mn}^{2+}_2\text{Si}_4\text{O}_{16}(\text{OH})_8 \cdot 18\text{H}_2\text{O}$
KOLICITE	$\text{Mn}_7\text{Zn}_4(\text{AsO}_4)_2(\text{SiO}_4)_2(\text{OH})_8$
KRAISSLITE	$\text{Fe}^{3+}_2\text{Mg}_4\text{Mn}_{14}\text{Zn}_6(\text{AsO}_4)_6(\text{AsO}_3)_4(\text{SiO}_4)_{12}(\text{OH})_{36}$
LAWSONBAUERITE	$(\text{Mn}, \text{Mg})_9\text{Zn}_4(\text{SO}_4)_2(\text{OH})_{22} \cdot 8\text{H}_2\text{O}$
LENNILENAPEITE	$\text{K}_{6-7}(\text{Mg}, \text{Mn}, \text{Zn}, \text{Fe})_{48}(\text{Si}, \text{Al})_{72}(\text{O}, \text{OH})_{216} \cdot 16\text{H}_2\text{O}$
LOSEYITE	$(\text{Mn}, \text{Mg})_4\text{Zn}_3(\text{CO}_3)_2(\text{OH})_{10}$
MAGNESIUM-CHLOROPHOENICITE	$(\text{Mg}, \text{Mn})_3\text{Zn}_2(\text{OH})_6[\text{As}_0.5\text{H}_0.5(\text{O}, \text{OH})_3]_2$
MARSTURITE	$\text{Mn}_3\text{CaNaHSi}_5\text{O}_{15}$
MCGOVERNITE	a complex $\text{Mg}, \text{Mn}, \text{Zn}, \text{Fe}^{3+}, \text{As}^{3+}, \text{As}^{5+}, \text{Si}, (\text{OH})$ mineral.
MINEHILLITE	$\text{K}_{2-3}\text{Ca}_{28}[\text{Zn}_{-4}\text{Al}_4\text{Si}_{40}\text{O}_{112}(\text{OH})_4](\text{OH})_{12}$
MOOREITE	$\approx \text{Mg}_9\text{Mn}_2\text{Zn}_4(\text{SO}_4)_2(\text{OH})_{26} \cdot 8\text{H}_2\text{O}$
NELENITE	$\text{Mn}_{16}\text{Si}_{12}\text{O}_{30}(\text{OH})_{14}[\text{As}^{3+}_3\text{O}_6(\text{OH})_3]$
OGDENSBURGITE	$\text{Ca}_3\text{ZnFe}^{3+}_6(\text{AsO}_4)_5(\text{OH})_{11} \cdot 5\text{H}_2\text{O}$
RETZIAN - (Nd)	$\text{Mn}_2\text{Nd}(\text{AsO}_4)(\text{OH})_4$
SCHALLERITE	$\text{Mn}_{16}\text{Si}_{12}\text{O}_{30}(\text{OH})_{14}[\text{As}^{3+}_3\text{O}_6(\text{OH})_3]$
STERLINGHILLITE	$\text{Mn}_3(\text{AsO}_4)_2 \cdot 4\text{H}_2\text{O}$
TORREYITE	$(\text{Mg}, \text{Mn})_9\text{Zn}_4(\text{SO}_4)_2(\text{OH})_{22} \cdot 8\text{H}_2\text{O}$
WALLKILLDELLITE	$\text{Ca}_4\text{Mn}^{2+}_6\text{As}^{5+}_4\text{O}_{16}(\text{OH})_8 \cdot 18\text{H}_2\text{O}$
YEATMANITE	$[\text{Mn}_5\text{Sb}_2][\text{Mn}_2\text{Zn}_8\text{Si}_4]\text{O}_{28}$

What Does Franklin Kiwanis Do?

ORGANIZATIONS SPONSORED OR SUPPORTED BY KIWANIS CLUB OF FRANKLIN

Franklin Mineral Museum	Franklin Head Start Program
Franklin Mineral Museum Foundation	Wallkill Valley Regional High School
Retired Franklin-Sterling Hill Miners	Franklin School
N. J. Kiwanis International Foundation	Hamburg School
Kiwanis International Foundation	Hardyston School
Kiwanis Youth Leadership Institute	Ogdensburg School
Salvation Army	Senior Citizens
Franklin First Aid Squad	Ogdensburg Day
Hamburg First Aid Squad	Franklin Band
Hardyston First Aid Squad	American Red Cross
Ogdensburg First Aid Squad	Local Churches
New Jersey Army National Guard	Special Christmas Funds
N. J. Special Olympics	
Sussex County Association For Retarded Citizens	

Boy Scouts of America:

- Morris-Sussex Council - BSA
- Pack 89 Ogdensburg
- Troop 89 Ogdensburg
- Pack 90 Franklin
- Troop 90 Franklin
- Pack 199 Franklin (For Special Children)
- Pack 200 Franklin (For Special Children)
- Pack 187 Hamburg

Sponsored Lectures & Exhibits From:

- Smithsonian Museum, Washington, D.C.
- Harvard University
- Rutgers University
- Pinch Museum, Rochester, N. Y.
- Paterson Museum, Paterson, N. J.
- Special Mineral Collections From Throughout The U. S.



Membership Committee
Franklin Kiwanis
Box 76
Franklin, N. J. 07416

Join Franklin Kiwanis and be a participant in community affairs. Meets Mondays at 7 PM the Fone Booth Restaurant

Fluorescent Minerals of Franklin and Sterling Hill, N. J.

A 1984 CHECK-LIST BASED ON OBSERVATIONS BY RICHARD C. BOSTWICK

*The fluorescence of most local minerals is brightest under short wave ultraviolet light (SW). Species marked with an *asterisk fluoresce brighter under long wave ultraviolet light (LW). Certain minerals fluoresce two colors under different wave-lengths; these are noted as follows: blue SW/cream LW. Unusual or rare fluorescent responses are listed in parentheses.*

- | | |
|--|---|
| *Aragonite: white to cream, (green SW) | Margarite: blue |
| Barite: white, blue-white, cream, tan, (pale green LW) | Margarosanite: blue, red SW/red, cream, orange LW |
| Barylite: violet | Mcallisterite: cream |
| Bassanite: violet | Meionite: red, (pink, yellow-orange, yellow, cream) |
| *Bustamite: red | Metalodevite: green |
| Cahnite: cream | Microcline: blue, red |
| Calcite: red, (pink, orange, cream, tan, green, blue-violet, etc.) | Mimetite: orange |
| Canavesite: violet | Minehillite: pale violet |
| *Celestite: cream, violet | Monohydrocalcite: green |
| *Cerussite: yellow | Nasomite: cream to yellow |
| Chondrodite: yellow | Newberryite: cream |
| Clinohedrite: orange | Oyelite: violet and white |
| *Corundum: red | Pargasite: pale greenish blue |
| Cuspidine: pale orange-yellow | Pectolite: orange |
| Diopside: blue SW/cream LW | Phlogopite: yellow |
| *Dypingite: blue | *Picropharmacolite: white |
| *Epsomite: cream | Powellite: yellow |
| Esperite: lemon-yellow | Prehnite: "peach" |
| *Ettringite: pale blue, but coated with cream-fl. gypsum | Quartz: cream to yellow green |
| Fluoborite: cream | Scheelite: yellow - red |
| Fluorapatite: orange, blue | *Smithsonite: yellow, orange-yellow |
| *Fluorite: green, blue-green, violet | *Sphalerite: orange, golden orange, blue, yellow |
| Guerinite: white | Svabite: orange |
| Gypsum: pale blue | *Talc: cream |
| Hardystonite: violet-blue | Thomsonite: cream |
| Hedphane: orange, cream | Tilasite: yellow, pink-orange (?) |
| *Hemimorphite: white, (green SW) | Titanite: tan, orange-tan |
| *Hodgkinsonite: red | Tremolite: blue, (yellow LW) |
| Hedyphane: orange, cream | Uranospinitite: green |
| *Hydrotalcite: cream | Uvite: yellow |
| Hydrozincite: blue | Willemite: green, (pale greenish yellow to orange) |
| Johnbaumite: orange | Wollastonite: orange to yellow |
| Magnesio-hornblende: pale greenish blue | Xonotlite: blue |
| Manganaxinite: red | *Zincite: yellow |
| | Zircon: orange |

827-9195

HAMBURG PHARMACY

S. L. PHARMACY, INC. — STEPHEN BERGER, R.P.

ROUTE 23

HAMBURG, N. J. 07419

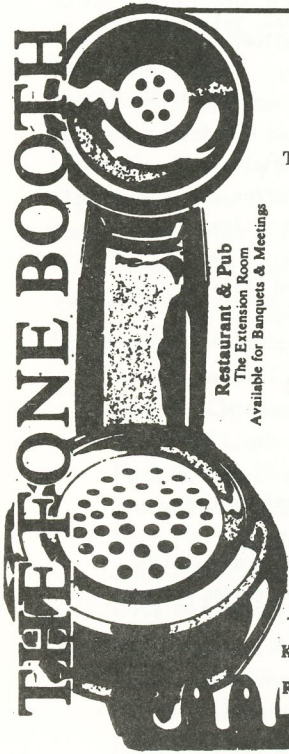

Entertainment
 COUNTRY
 WESTERN
 And Oldies
 PAUL LARSON
 &
 THE REFLECTIONS

Fri. & Sat.

JEFF GAYNOR

Monday Eve.

ALLEN CARPET

Thurs. Eve.

JO JO RUSSEL

Sun. Eve.

Oldies but Goodies!

LUNCH SPECIALS
DAILY

Some Specialties
of the House

- Roast Duck
 - Seafood delite
 - Scallops Mediterranean
 - Chefs Dinner Special's
Daily
- Open 7 Days

HAPPY HOUR

Mon. thru Fri. 4 'til 7 pm,
Kitchen open late every nite

Rt. 23, Franklin - 827-2090
Major Credit Cards

PRIME RIB SPECIAL

\$7.95

Thursday thru Monday
incls., Salad, Baked Potato,
& Loaf of Fresh Bread

Come Dine & Dance in the
Extension Room
Friday & Saturday Evenings.

Separate Salad Bar

*Also Available For Banquets,
Parties and Meetings
(up to 120 people)*

MEMBER WALLKILL VALLEY CHAMBER OF COMMERCE
Plenty of parking available after 6 PM
At C&W & K&K parking lots next to restaurant

Compliments of

CLARENCE and MARIAN CASE

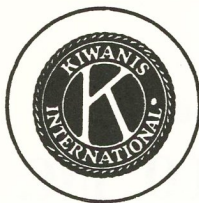

SPEAKERS

SATURDAY:
October 6, 1984

1:00 P.M.

Prof. PAUL BRIAN MOORE
University of Chicago
"Franklin, NJ - a perspective"

3:00 P.M.

Prof. PETER B. LEAVINS
University of Delaware
"Minerals of the Franklin Marble"

SUNDAY:
October 7, 1984

1:00 P.M.

MANUEL A. ROBBINS *author of The
Collectors Book of Fluorescent Minerals*
RCA - Cherry Hill, NJ

and
RICHARD C. BOSTWICK
SPEX Industries, Metuchen, NJ

*"Franklin, NJ vs the World: An examination
and comparison of fluorescent minerals"*

Micromount Demonstration

by Russ DeRoo

with Video Micro-screening by Walter Zabinski

HAMBURG PLUMBING SUPPLY CO., INC.

WHOLESALE PLUMBING & HEATING SUPPLIES

RT. #23 SOUTH & PRINCE ST.
HAMBURG, N. J. 07419

201 - 827-2553

827-6565

"Pizza is our Specialty"

JOLLY PIZZA

RESTAURANT & PUB

DINNER MENU * COCKTAILS * TAKE OUT ORDERS

Bring The Family To Our New Dining Room
Open 7 Days — Mon. - Sat., 11 A.M. to 11:30 P.M.
Sun. 4 to 10:30 P.M.

27 ROUTE 23

FRANKLIN, N. J.

Convenient — Across From The Armory

Annual Franklin-Sterling Hill Mineral Show

EXHIBITORS

LEE & JENNIE ARESON
JOHN L. BAUM
PHILIP P. BETANCOURT
RICHARD C. BOSTWICK
JOSEPH CILEN
RUSS de ROO
HARVARD UNIVERSITY
RICHARD & ELNA HAUCK
JOHN KOLIC
JOHN KUZMA
WARREN E. MILLER
PATERSON MUSEUM
DON PHISTER
PINCH MINERALOGICAL MUSEUM
RUTGERS UNIVERSITY
JOHN E. SEBASTIAN
AL SMITH
WILFRED R. WELSH

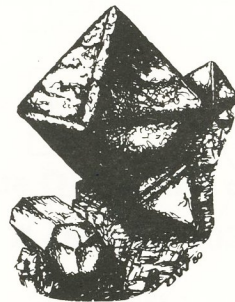

Exhibits courtesy of the Franklin-Ogdensburg Mineralogical Society, Inc.
John Cianciulli - Exhibits Chairman

FRANKLIN-STERLING HILL MINERAL SHOW
KIWANIS CLUB of FRANKLIN
Franklin, New Jersey
National Guard Armory

MAIN ENTRANCE

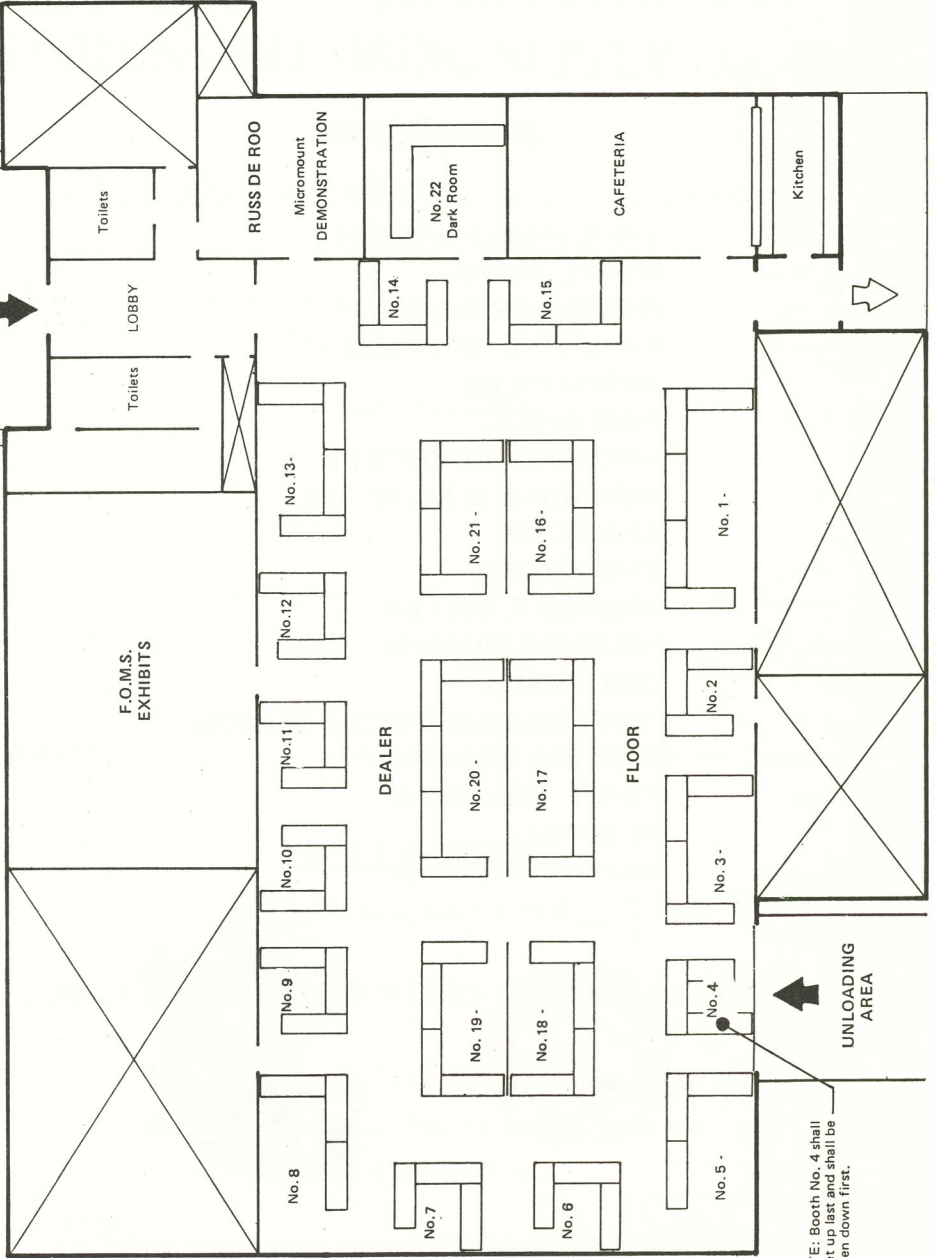

NOTE: Booth No. 4 shall be set up last and shall be broken down first.

Scale: 1/16" = 1'-0"

Drill Floor 60' X 120'

BUS PICK-UPS

MINERAL DEALERS ATTENDING THE 1984 FRANKLIN-STERLING MINERAL SHOW

1. Mineral Showcase, 21 Irwin Ave., Middletown, N.Y. 10940
 2. Excalibur Mineral Co., 7 Grover Road, Dover, N.J. 07801
 3. Merker Minerals, 416 Bowen Street, Dayton, Ohio 45410
 4. Treasures To Wear, 13 Earlwood Drive, Poughkeepsie, N.Y. 12603
 5. Gilman's, E. Durham, Box 103, Hellertown, PA. 18055
 6. HORN MINERALS, 263 No. Country Road, Smithtown, N. Y. 11787
 7. Aurora Mineral Corp., 81 West Merrick Rd., Freeport, N.Y. 11520
 8. The Silver Pick, 1682 St. Johns Ave., Merrick, New York 11566
 9. Lawrence H. Conklin, 62 St. John's Place, New Canaan, CT. 06840
 10. Ake L. Anderson, 31 Prospect St., Huntington, L.I., N.Y. 11743
 11. David M. Crawford, 1808 Harlem Blvd., Rockford, Illinois 61103
 12. The Mineral Cabinet, P.O. Box 814, New Providence, N.J. 07974
 13. The Rocksmiths, 5th & Toughnut, P.O. Box 157, Tombstone, Arizona 85638
 14. The Gemmery, R.D. 3, Box 397, Sussex, N.J. 07461
 15. Jim's Gems Inc., 1581 Route 23 South, Wayne, New Jersey 07470
 16. Schmitz Lapidary, 120 Center Street, Pompton Lakes, N. J. 07442
 17. Martins Minerals, P.O. Box 811, Willoughby, Ohio 44094
 18. The Lesnicks, 8405 Rawhide Tr., Tucson, Arizona 85715
 19. Howard Minerals, 2775 Bedford Ave., Brooklyn, N.Y. 11210
 20. Roberts Minerals, P.O. Box 1267, Twain Harte, California 95383
 21. Rainbow Gemcraft, 125-11 103rd Ave., Richmond Hill, New York 11419
-



Compliments of

**The OFFICERS and MEN
Co. A - 5th Bn. 102nd Armor**

FRANKLIN, N. J.

827-7870

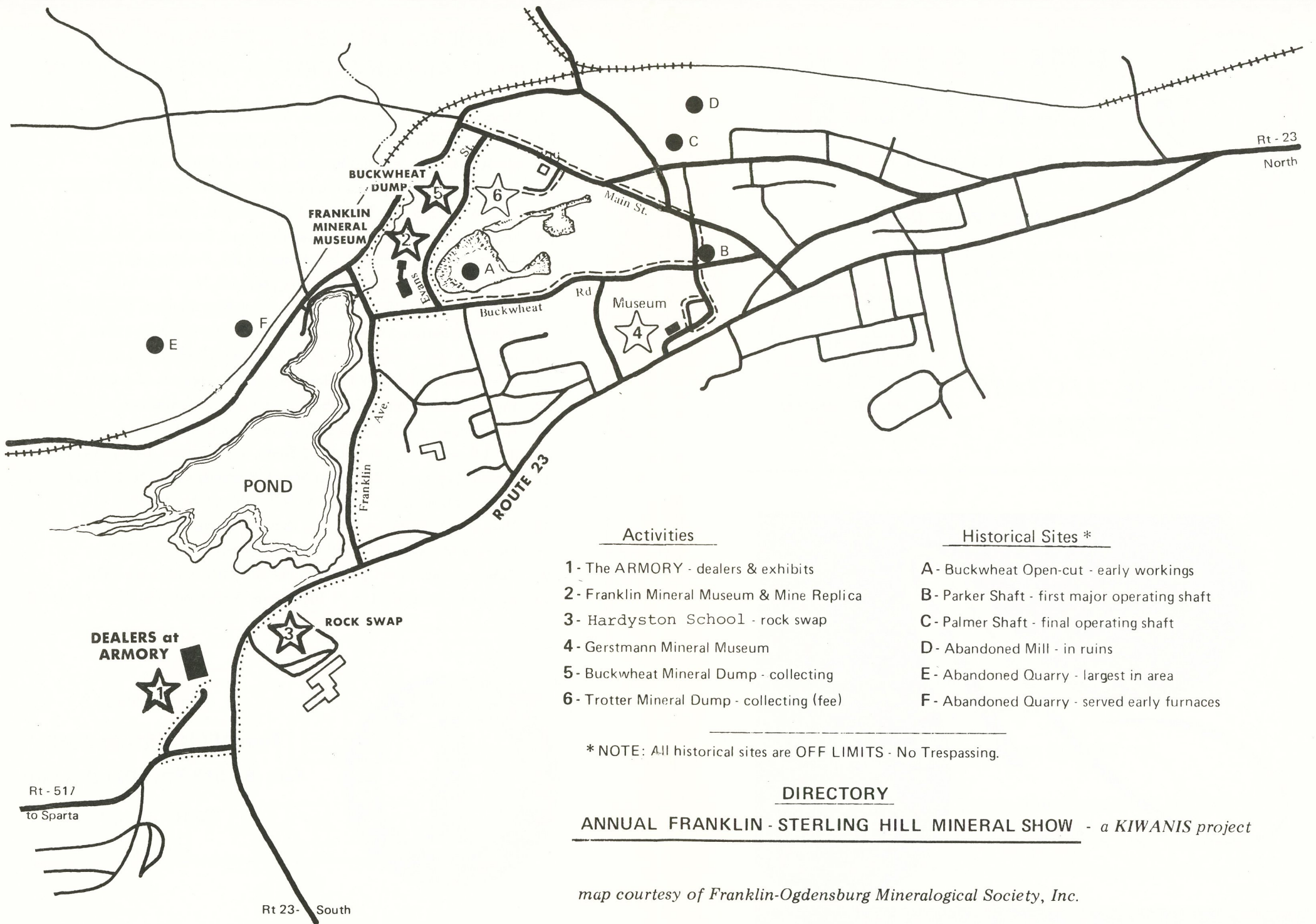

Activities

- 1 - The ARMORY - dealers & exhibits
- 2 - Franklin Mineral Museum & Mine Replica
- 3 - Hardyston School - rock swap
- 4 - Gerstmann Mineral Museum
- 5 - Buckwheat Mineral Dump - collecting
- 6 - Trotter Mineral Dump - collecting (fee)

Historical Sites *

- A - Buckwheat Open-cut - early workings
- B - Parker Shaft - first major operating shaft
- C - Palmer Shaft - final operating shaft
- D - Abandoned Mill - in ruins
- E - Abandoned Quarry - largest in area
- F - Abandoned Quarry - served early furnaces

* NOTE: All historical sites are OFF LIMITS - No Trespassing.

DIRECTORY

ANNUAL FRANKLIN - STERLING HILL MINERAL SHOW - a KIWANIS project

map courtesy of Franklin-Ogdensburg Mineralogical Society, Inc.



FULL SERVICE CATERING

By RITA & DOUG THOMSON

PIZZA PLUS Restaurant

ROUTE 23
HAMBURG, N. J. 07419
(201) 875-5990

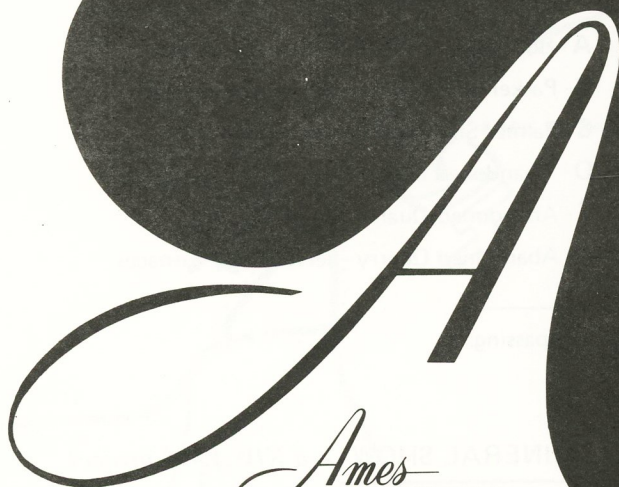
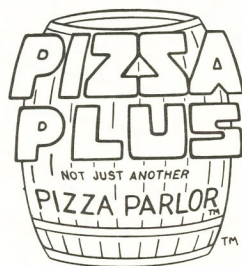

Ames
RUBBER CORPORATION
23-47 AMES BOULEVARD
HAMBURG, N.J. 07419



Members of the National and N.J. Waterwell Assoc.

"IT MUST BE DUNN"

Since 1946

Dunn & Dunn, Inc.

**WELL DRILLING CONTRACTORS
55 Walnut St., Sussex, N.J.**

**The Very Latest Drilling Equipment
and Methods in the Area**

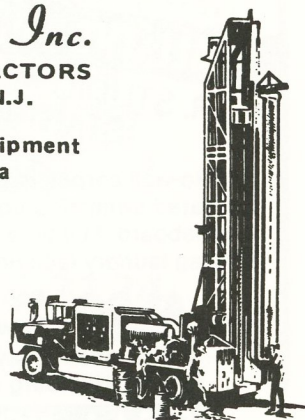

(Office & Yard, Rt. 23)

Allen V. Dunn, Pres.
N.J. Master's License #746
Phone 875-4503

Alan W. Clark, V. Pres.
N.J. Master's License #772
Phone 875-5347

William H. Frey Co., Inc.

Insurance Service Since 1901

ALL LINES OF INSURANCE

- AUTOMOBILE
- FIRE (PERSONAL & COMMERCIAL)
- HOMEOWNERS
- LIFE & ACCIDENT
- GROUP LIFE & MAJOR MEDICAL
- MARINE
- UMBRELLAS
- FIDELITY & SURETY BONDS (POWER OF ATTORNEY)
- FARMS
- COMMERCIAL & PERSONAL PACKAGE POLICIES

383 ROUTE 23, BOX 295

FRANKLIN, N.J. 07416

(201) 827-9720

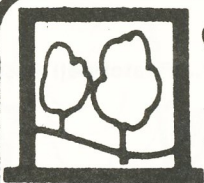

CARLTON VILLAGE

THE APARTMENTS!

100-ACRE
Heavily Wooded Site in Sussex County

ALL THE PRIVACY YOU WANT

1 BR. STUDIO • 1 BR. DELUXE • 2 BR.
STARTING from \$370. **AND SO MUCH MORE**

Wall-to-wall carpet, large private patios and balconies.
2 Heated swimming pools, pitch & puff golf course —
shuffleboard. Full-time superintendent service.
Maytag laundry facilities. Sorry, no pets.

ALSO 2 and 3-Bedroom
Townhouses FOR SALE.

Office open 7 days a week — Located on
Rte. 94, Hamburg (2 miles south of Rte. 23)

CALL 201-827-6676

LIMITED SALES!!!!

NEW TOWNHOUSES
WITH GARAGES

NOW AVAILABLE AT

WALDEN

in Carlton Village

Rt. 94 (2 miles south of Rt. 23)
Hamburg, N.J. • (201) 827-6834
11 a.m. to 5 p.m. daily

ATTRACTIVE FINANCING AVAILABLE

Compliments of . . .

Vic & Chuck Marotta

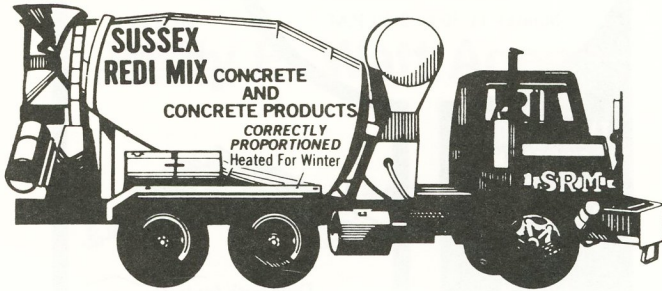

SEPTIC TANKS
AND
PARKING
BLOCKS



875-3124

RT 23

SUSSEX, N.J.

the QUARRY



Camping
Swimming
Scuba Diving
Cross Country Skiing

MINERAL COLLECTING

R.R. 2 - Box 632
Route 517
Hamburg, N. J. 07419
(201) 827-4200

the new
valley view

Champagne Buffet Brunch
Sunday 11:30 to 2:30 P.M.

**MOTEL
LOUNGE
RESTAURANT**

**TV-AIR COND.
SWIMMING
POOL
24 HR. DESK
SERVICE**

LUNCH
MON. - SAT.
11:30 AM - 4:00 PM
DINNER
MON. THRU SUN.
5:00 P.M. TO 9:30 P.M.
FRI. & SAT.
5:00 P.M. TO 10:00 P.M.

**ALL MAJOR
CREDIT CARDS
729-3144**



Dine with fantastic
View of the Valley

Upstairs Dining Room
with Fireplace

Ground Floor
Dining and Pub

53 SPARTA AVE. SPARTA, N. J.

We're here for you.



The National Bank
OF SUSSEX COUNTY MEMBER FDIC

MEMBER FEDERAL DEPOSIT INSURANCE CORPORATION

GENERAL INSURANCE

Harry E. Watt Agency

2 ROWE PLACE, FRANKLIN, N.J. 07416
827-9080

Agents For

SELECTED RISK INS. CO. • HARTFORD INSURANCE CO.

WM. D. SCOTT
MARIE J. SCOTT

If you can't find it
anywhere, TRY ...



WILCOX

Office Supplies & Equipment

FOR
Printing WITH THE LOOK OF *Distinction* *

6 MAIN STREET • HAMBURG, N. J. 07419 • 827-7474

RELIABLE and DURABLE - OVER 60 YEARS ON MAIN STREET

TEL: (201) 827-5740

樓 福 萬
SZECHUAN GARDEN
CHINESE RESTAURANT
Szechuan, Mandarin and Cantonese Cuisine
Orders to Take out

Shoprite Shopping Center
Route 23—Franklin, N.J. 07416

Tel. 875-5438

Handcrafted Sterling Silver Jewelry

THE GEMMERY

J & J WITHEY

R.D. 3, BOX 397

SUSSEX, N. J. 07461

(201) 875-3550

HOME MADE BREAD & PIES

THE ELIAS COLE

FINEST FOODS PREPARED IN THE SLOCKBOWER TRADITION

ROUTE 23

(5 Miles North of Sussex)

COLESVILLE, N. J.



Delivery Service



AMERICAN
GREETINGS
PRESCRIPTIONS

Russell Stover
CANDIES

- Gifts
- Baby Needs
- Cosmetics
- Jewelry
- Discount Film Processing
- Photo Supplies
- Newspapers, Magazines
- Lottery Tickets
- Sick Room Supplies & Rentals

MON-FRI 9-9
SAT 9-6 SUN 9-1

Prescription
Plans Honored

24 Hour  Emergency Service



827-7107



RT. 23 (Next to A&P) FRANKLIN



THE SILVER PICK

Karl R. Vossbrinck
FR 8-9051

1682 St. Johns Ave.
N. Merrick, New York 11566

(201) 875-3640

SUSSEX SALES & SERVICE

Authorized Dealer for
Products of Ford Motor Company
FORD — MERCURY — FORD TRUCKS

ROUTE 23, P.O. BOX 385

SUSSEX, N. J. 07461

**DUNKIN'
DONUTS**®

HAVE COFFEE &
DONUTS WITH US —
1 Mile North on Route
23, Franklin, N. J.

Save 50¢
Ask For The Show Special — Doz. Donuts \$2.19



47 Church St.
Franklin, N.J.
827-7135

**TV and
APPLIANCE
CENTER**

61 Sparta Ave.
Sparta, N.J.
729-3141

(212) 434-8538

HOWARD MINERALS

RARE SPECIES — MICROMOUNTS — FREE LIST

SEND US YOUR SPECIES — WANT LIST

P.O. BOX 56, VANDERVEER STATION

BROOKLYN, N. Y. 11210



**HAUCK'S
COLLECTIBLES**

*Elna and Richard Hauck
8 Rowe Pl., Bloomfield, N. J. 07003*

(201) 743-1030

(201) 464-7235

THE MINERAL CABINET

NEW JERSEY MINERALS — WORLD WIDE SPECIMENS

P.O. BOX 814

NEW PROVIDENCE, N. J. 07974

COMPLIMENTS OF . . .

NANCY and BILL KULSAR

Office: (201) 827-7000

Regional

HARDEN FUEL OIL CO.
FUEL OIL — GASOLINE

P.O. BOX 357

FRANKLIN, N. J. 07416



TELEFLORIST

827-3949

JONES FLORIST

FLOWERS FOR ALL OCCASIONS

All Major Credit Cards

ROUTE 23, 221 SOUTH

HAMBURG, N. J. 07419



upstream farm

CORKHILL ROAD FRANKLIN, N. J.

BREEDING THE STANDARD BRED RACE HORSE!

- OUR STALLIONS -

NO NUKES P. 152 1/5 ♦ LINDY'S CROWN 154 T. 4/5 *WORLD CHAMPION*



THOMAS J. WEBB

Apiaries in North and Central Jersey

R.D. 4 — BOX 391 SUSSEX, N. J. 07461

(201) 875-3889

Beekeeping Supplies

827-7327

NICK ZIPCO, Manager

TROTTER MINERAL DUMP

Open 7 Days A Week — Year Round

MAIN STREET

FRANKLIN, N. J.

827-9141



390 RUTHERFORD AVE.

FRANKLIN, N. J.

RAINBOW GEMCRAFT

BEST QUALITY: GEM ROUGH FINISHED GEMSTONES
 BETTER JEWELRY MINERAL SPECIMENS

At Your Service at the Franklin Show, and at:

Pikesville, Md. October 27-28, 1984
Garden City, L.I., N.Y. November 10-11, 1984
Hempstead, N.Y. March 2-3, 1985

BETTY & ERNIE NAPLES

RICHMOND HILL, N.Y.

COMPLIMENTS

ACKERSON PUMP CO.

BIG SPRING ROAD - FRANKLIN, N. J. 07416

827-6088

Compliments of . . .

WEISS' CLOTHING STORE

Levi, Wrangler, Lee, Keds, Devon, Billy The Kid

Clothes for the Entire Family

111 MAIN STREET

FRANKLIN, N. J.

We Are Looking Forward to Seeing You At The

FRANKLIN DINER

JACK and JOYCE CARROLL, Props.

ROUTE 23

FRANKLIN, N. J.

(201) 875-4191

(201) 875-7700

SUSSEX MOTEL

Swimming Pool ★ Year-Round Temperature Control
Cable T.V. ★ Efficiency Units



Route 23, Sussex
New Jersey 07461

827-9966

JIM BUCHER, Manager

EXXON

FRANKLIN EXXON

ALL GENERAL REPAIRS — TOWING & ROAD SERVICE

STATE INSPECTION

ROUTE 23

FRANKLIN, NEW JERSEY 07416

GILMAN'S

"AT THE CAVE"

Box 103

Hellertown, Pa. 18055

YOUR COMPLETE LAPIDARY SUPPLY HOUSE

Phone 215/838-8767

Open every day 9 a.m. to 6:30 p.m.

Tel. 827-7670

HAMBURG HARDWARE CO.

**HARDWARE—ELECTRICAL SUPPLIES
PLUMBING SUPPLIES—DE VOE PAINT**

1 MAIN STREET

HAMBURG, N. J.

MURRAY'S MINI MARKET

FULL SERVICE DELI & CATERING

Open 7 A.M. - 11 P.M. — 7 Days

342 MAIN STREET

OGDENSBURG, N. J.

875-6101



H & S CHEVROLET, Inc.

NEW CARS — USED CARS — PARTS — RELIABLE SERVICE

ROUTE 23
at the Traffic Light

2 WALLING AVE.
SUSSEX, N. J.



National Community Bank of New Jersey

*"New Jersey's PREEMINENT
BANK — since 1895"*

Member F.D.I.C.

(201) 464-7235

THE MINERAL CABINET

MINERAL COLLECTION PURCHASED
OR WE WILL BROKER YOUR COLLECTION

P.O. BOX 814

NEW PROVIDENCE, N. J. 07974

Handcrafted
Silver Jewelry

14 K Gold Fill
Wire Wrap

TREASURES TO WEAR

POUGHKEEPSIE, N. Y.

Unusual Minerals in Unique Mountings. We Will Work With Our Stones or Yours

Phone (914) 471-4161

MURRAY'S MINI MARKET

FULL SERVICE DELI & CATERING

Open 7 A.M. - 11 P.M. — 7 Days

342 MAIN STREET

OGDENSBURG, N. J.

Phone: 827-9980

Doug Agne, Prop.

OGDENSBURG EXXON SERVICENTER

TUNE UP & ELECTRICAL SPECIALISTS — BRAKE & FRONT END WORK

MAJOR & MINOR REPAIRS — AIR CONDITIONER SERVICE

13 MAIN STREET

OGDENSBURG, N. J. 07439

827-7943



EARL'S OGDENSBURG GULF

COMPLETE AUTO REPAIRS — U-HAUL

186 SOUTH MAIN STREET

OGDENSBURG, N. J. 07439

(201) 827-4666

94 MOTOR LODGE

LUXURIOUS ACCOMMODATIONS

REASONABLE RATES

5 Min. Action Park

2 Min. Great Gorge Ski Resort

ROUTE 94

McAFEE, N. J. 07428

The SUSSEX COUNTY STATE BANK

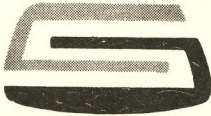

"The BANK With the Personal Touch"

399 ROUTE 23, P.O. BOX 353
FRANKLIN, N. J. 07416
(201) 827-2404

CHURCH STREET
VERNON, NEW JERSEY 07462
(201) 764-6175

CLOVE ROAD, BOX 1070
MONTAGUE, NEW JERSEY 07827
(201) 293-3488

172 WOODPORT ROAD
SPARTA, NEW JERSEY 07871
(201) 729-7223

HOURS

	LOBBY	DRIVE-IN
Mon.	9 AM - 3 PM	8 AM - 6 PM
Tues.	9 AM - 3 PM	8 AM - 6 PM
Wed.	9 AM - 3 PM	8 AM - 6 PM
Thur.	9 AM - 3 PM	8 AM - 8 PM
Fri.	9 AM - 3 PM 6 PM - 8 PM	8 AM - 8 PM
Sat.	9 AM - 12 Noon	9 AM - 3 PM

Member Federal Deposit Insurance Corporation



Photo by ERNIE DUCK

THE FRANKLIN MINERAL MUSEUM and MINE REPLICA

SEE THE WORLD FAMOUS FRANKLIN MINERALS, MINING HISTORY, FLUORESCENT DISPLAY AND A TRUE REPLICA OF THE MINING OPERATIONS HUNDREDS OF FEET BELOW THE SURFACE OF THE EARTH.

SALES AREA: — Mineral Lights, Specimens,
Souvenirs and jewelry available.

NEW OPERATING SCHEDULE

SPRING (April 15 - June 30)* and FALL (Sept. 1 - Nov. 15)

Monday: Closed. Tues., Wed., Thurs.: Groups, by Reservation.

Fri. & Sat.: Open to Public 10 a.m. - 4 p.m.

Sunday: Open to Public 12:30 p.m. - 4:30 p.m.

SUMMER (July, Aug.): Mon., Tues.: Closed.

Wed. thru Sat.: Open to Public 10 a.m. - 4 p.m.

Sunday: Open to Public 12:30 p.m. - 4:30 p.m.

*Closed Easter



*This is a Franklin Kiwanis sponsored,
non-profit, Community project.*

Gifts and donations to the Museum are tax deductible.

6B Evans Street, Box 54, Franklin, N. J. 07416
(201) 827-3481